



PHASE 2 UNDERGRADUATE RESIDENCE HALLS



General Information

You may be interested to know:

- **Is this like before Phase 2 when there was an owner other than DKU?** No, DKU is the owner of the building
- **Who lives here?** Only and all undergraduates
- **How many students can live here?** A max of just over 500 students can live in each of 4 Courtyards
 - Courtyard 1: Buildings A and B (Community color: Green)
 - Courtyard 2: Buildings C and D (Community color: Red)
 - Courtyard 3: Buildings E and F (Community color: Orange)
 - Courtyard 4: Buildings G and H (Community color: Blue)
- **How much does it cost?** Since the Chinese Ministry of Education prohibits room charge rate increases for specific students as they complete their university studies and since DKU's costs increase, flat rates are not used. The room charge is:
 - Double: ¥7,000/semester for those matriculating fall 2020 or before and ¥7,500/semester for those matriculating after fall 2020
 - Single: ¥9,000/semester for those matriculating fall 2020 or before and ¥9,500/semester for those matriculating after fall 2020

Amenities

All of this information is subject to change. Housing is a completely separate office from Residence Life. While Residence Life is responsible for room assignments and events, Housing is responsible for cleaning, maintenance, inspections, and most amenities. Please direct all inquiries appropriately.

Each Room

- 2 students live in every room, accessible with your DKU ID
- Beds are 2.1 m x 0.97 m. In 7 of the 8 residence halls, the furniture is as pictured below, with each side of the room being the mirror image of the other side. In the 8th residence hall, there is one bunked bed (for 2 students) on one side of the room and there are two desks on the other side of the room
- The AC system is centralized, but each room comes with fan speed control for manual adjustment
- Refrigerators are not allowed in your room, but there is public refrigerator space in the 1F kitchen
- Cabinets are lockable

Each Residential Floor

On each floor, except for the first, there are:

- 60 – 80 students living there
 - Freshmen will live on floors specifically designated for Freshmen
 - Upperclassmen will live together in rooms & on floors specifically designated for Upperclassmen
 - Most floors will be gender segregated, though co-ed floors are offered.
 - For co-ed floors, students are assigned with roommates of same gender. Each gender will be assigned to opposite wings on the floor.
- 4 or more bathrooms, each of which:
 - Has 3 or more showers
 - Has 3 or more toilets
 - Is cleaned and sanitized regularly by Housing staff
- 2 or more team rooms per floor, each of which can hold 6 or more people
- Waste disposal locations

1st Floor

The first floor of each residence hall is a social hub of the community. On the first floors, students will find:

- Large common spaces for socializing and hosting activities, with vending machines
- Furnished and supplied (oven, cooktop, microwave, refrigerator, and freezer) community kitchens
- Laundry rooms
- ePrint stations
- Residence hall helpdesks, staffed by Residence Life Office Assistants, by Residence Life Coordinator offices
- Academic classrooms
- Storage rooms for student belongings. The process for accessing this storage is co-managed by Residence Life and Operations

Miscellaneous

You may be wondering:

- **Where is the closest drinking water?** There's a hot/cold water machine in the kitchen of each first floor
- **What is the Housing inspections process for the building?** Housing (dkuhousing@dukekunshan.edu.cn) inspects each room each week to ensure safety
- **Where can I pick up mail and packages?** There is delivery locker outside the SRH in the corner near the field and the Service Building (SRH 3105)
- **What is the physical address?** DKU's main campus
- **Where is the nearest bicycle storage?** There is covered and uncovered storage near the building entrances
- **Where is the nearest place for parking a car?** There are parking lots near, but none specifically for, the buildings

Floorplan

A sample half floorplan of a residential floor is below with bedrooms in blue, bathrooms in dark green, and team room in light green.

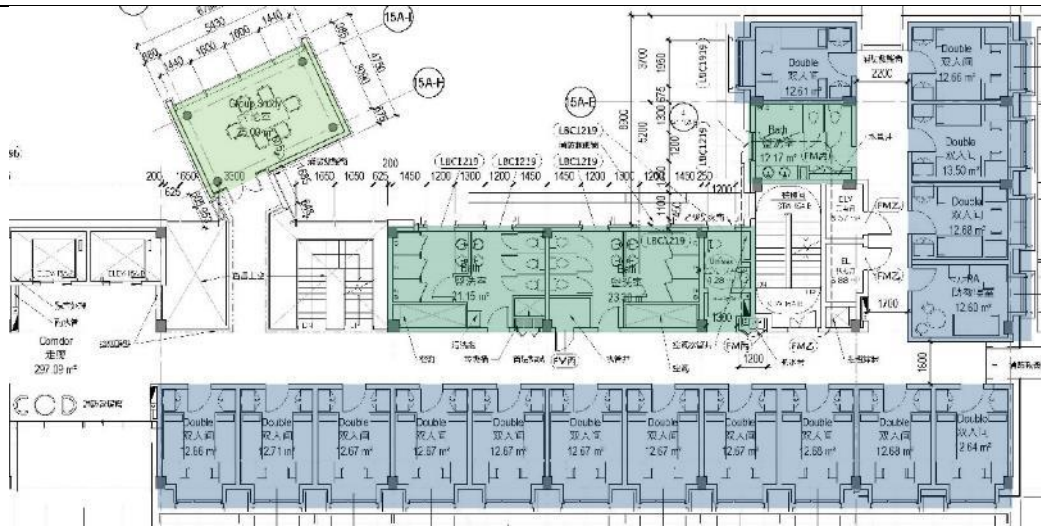

Bedroom & Common Space Renderings

